

Installation Guide

Saturn-T1000

Version: 1.0



Revision History

Revision	Date	Author	Reviewer	Description
V1.0	06/13/2025	Stella Xia		Original Document

1 Dimensions

Unit: mm

Top View

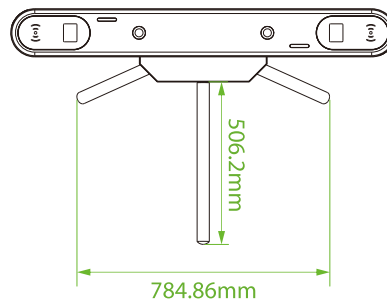

Side View

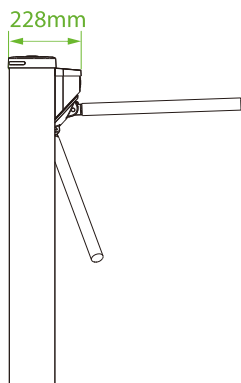

Front View

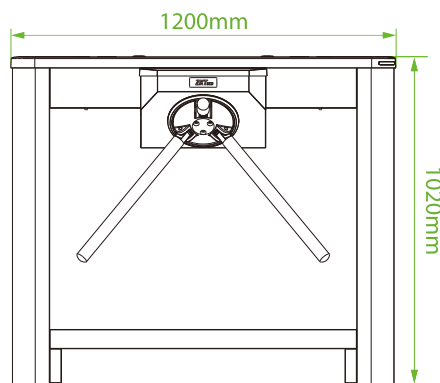

Side View

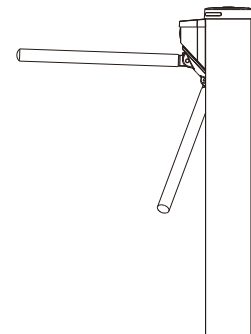

Bottom View

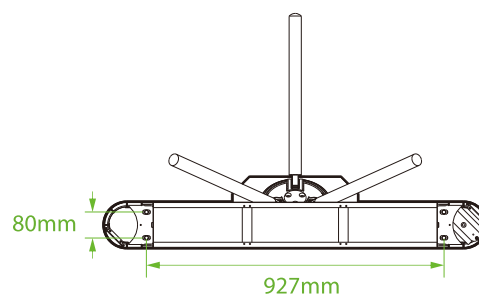

2 Installation Requirements

1. It is recommended that the device be installed on a level and solid floor. If the floor is uneven or not strong enough to hold the device in place, resurface the floor or use a pedestal mount to alleviate the change problem.
2. Avoid using the device directly in open air or wet, corrosive environments where rain, moisture, or corrosive materials may impact its lifespan. Use it only if the device is explicitly rated for waterproofing.
3. Make sure the device's grounding wire is securely connected. Differentiate between strong and weak power setups to prevent potential harm to personal safety and unforeseen incidents.
4. After installation, inspect the grounding wire, connectors, junctions of the connecting line, and moving parts to ensure secure connections. Tighten any loose nuts, screws, or fasteners promptly to prevent long-term gate failure.

3 Installation Environment

Refer to the provided figure to identify the installation position based on the device's size and space requirements. When installing against a wall, leave a 100mm space to allow for opening the top cover during commissioning and maintenance. Maintain a 100mm distance between two devices if multiple channels are present.

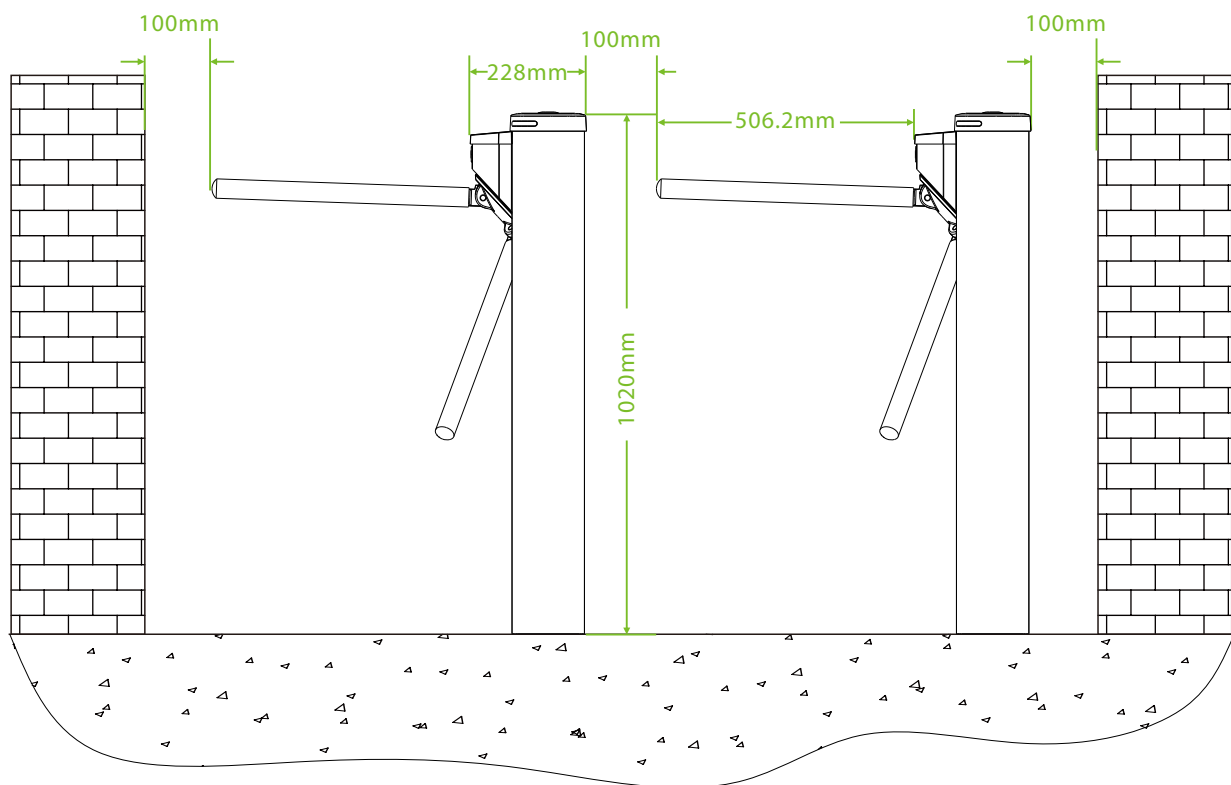

4 Installation

Step 1 After checking the list to ensure all devices and items are correct, transport the device to its installation location.

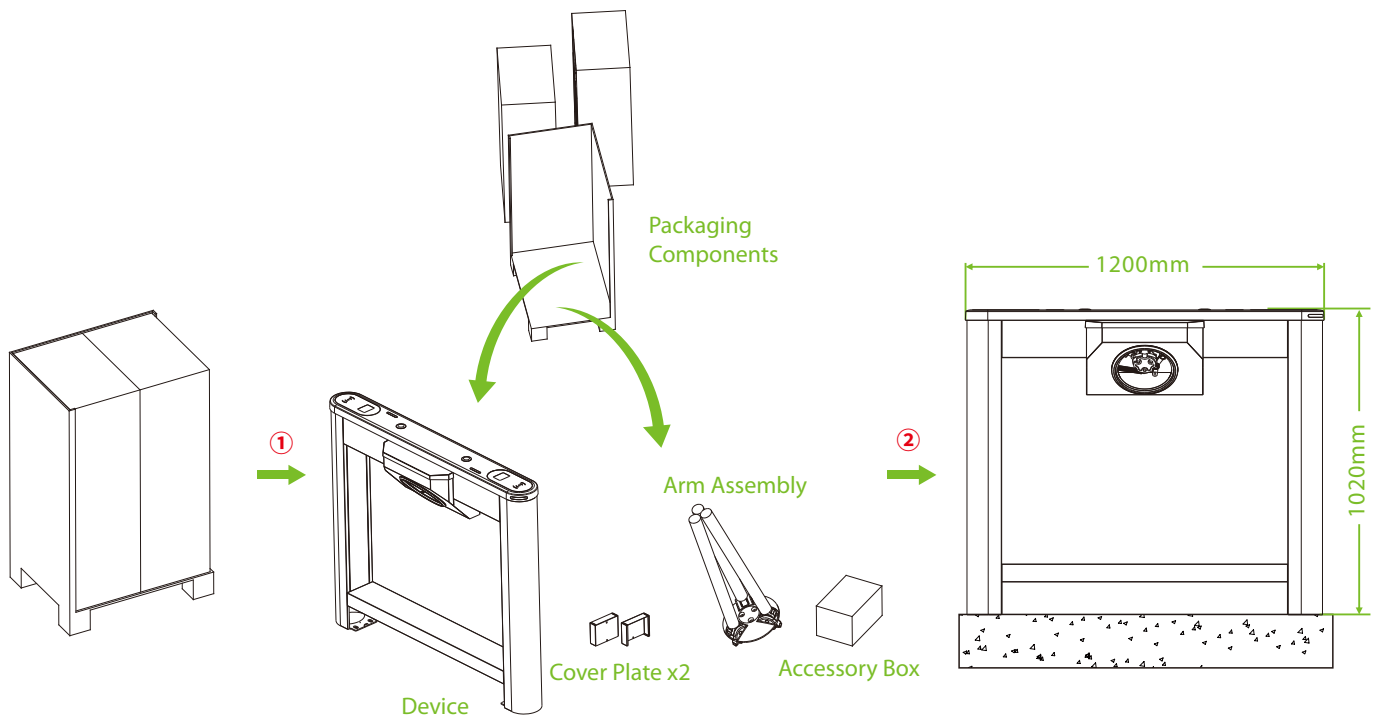

Step 2 Draw the location of the cabinet with a marker and mark each location of the mounting holes. There will be a total of four mounting holes and two wire holes per cabinet. Remove the four screws hidden under the top lid, then remove the top lid.

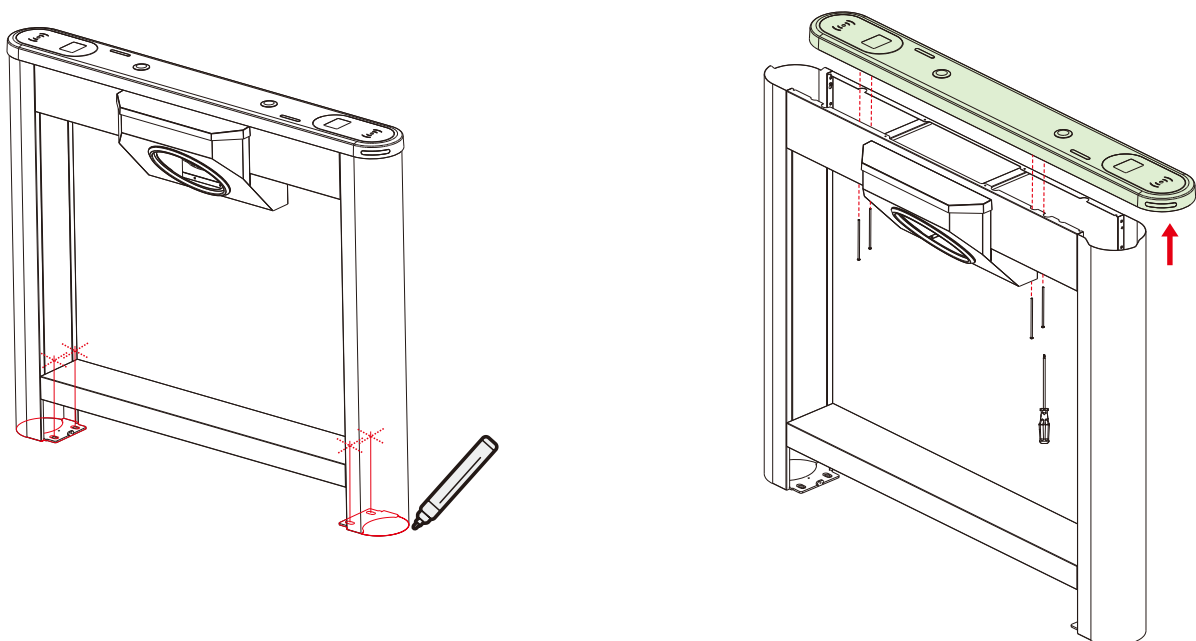

Step 3 Drill Holes and Place Bolts

1. Using a concrete drill bit, drill the mounting holes **60mm** in depth at the center of each marked location.
2. Then insert the bolts vertically into the mounting holes as shown at right.
3. Make sure the bolts are placed in place. Use a hammer to tap the bolts into place, if needed.

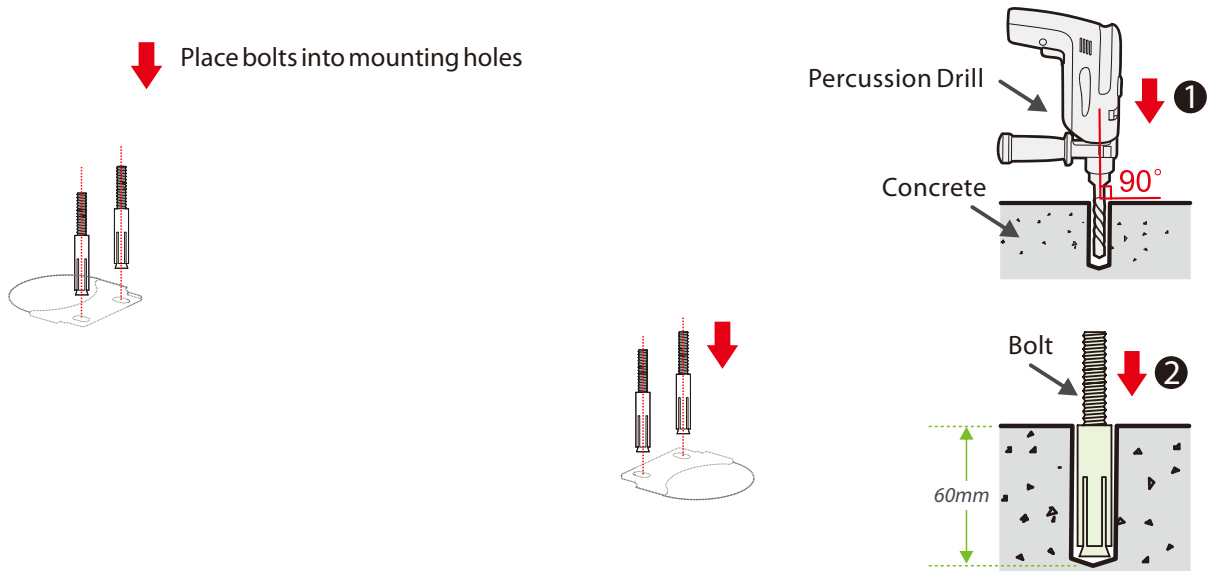

Step 4 Wireway Laying

1. Dig two recesses of **50mm** depth at the wire holes on both sides of the cabinet with the dimensions shown below. Recesses are dug at positions ① and ②.
2. Then lay two **25mm** diameter PVC pipes as shown below.
3. After threading the cable out of the PVC pipe, pour concrete to fix it in place.

Top View

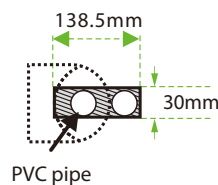
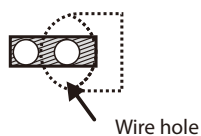

Position of the notch:

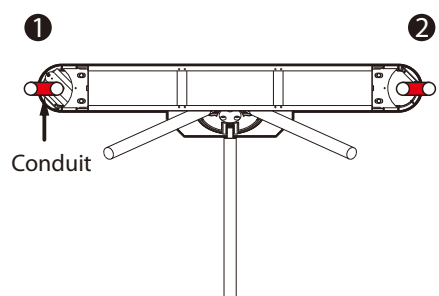

Side View

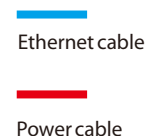
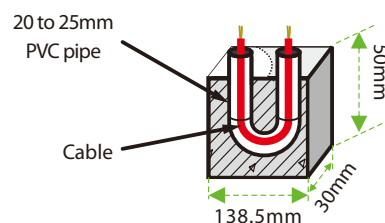
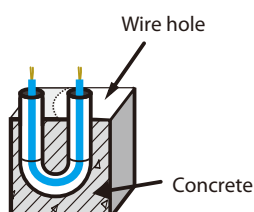
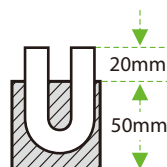
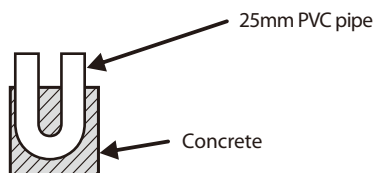

Step 5 Fixed Cabinet

1. After laying the PVC pipe, place the cabinet alignment bolts back into the mounting position.
2. Then insert the four washers and nuts into the bolts one by one.
3. Tighten the nuts to hold the cabinet in place. Don't tighten it completely until after you're sure it won't move anymore. The finished result is shown below:

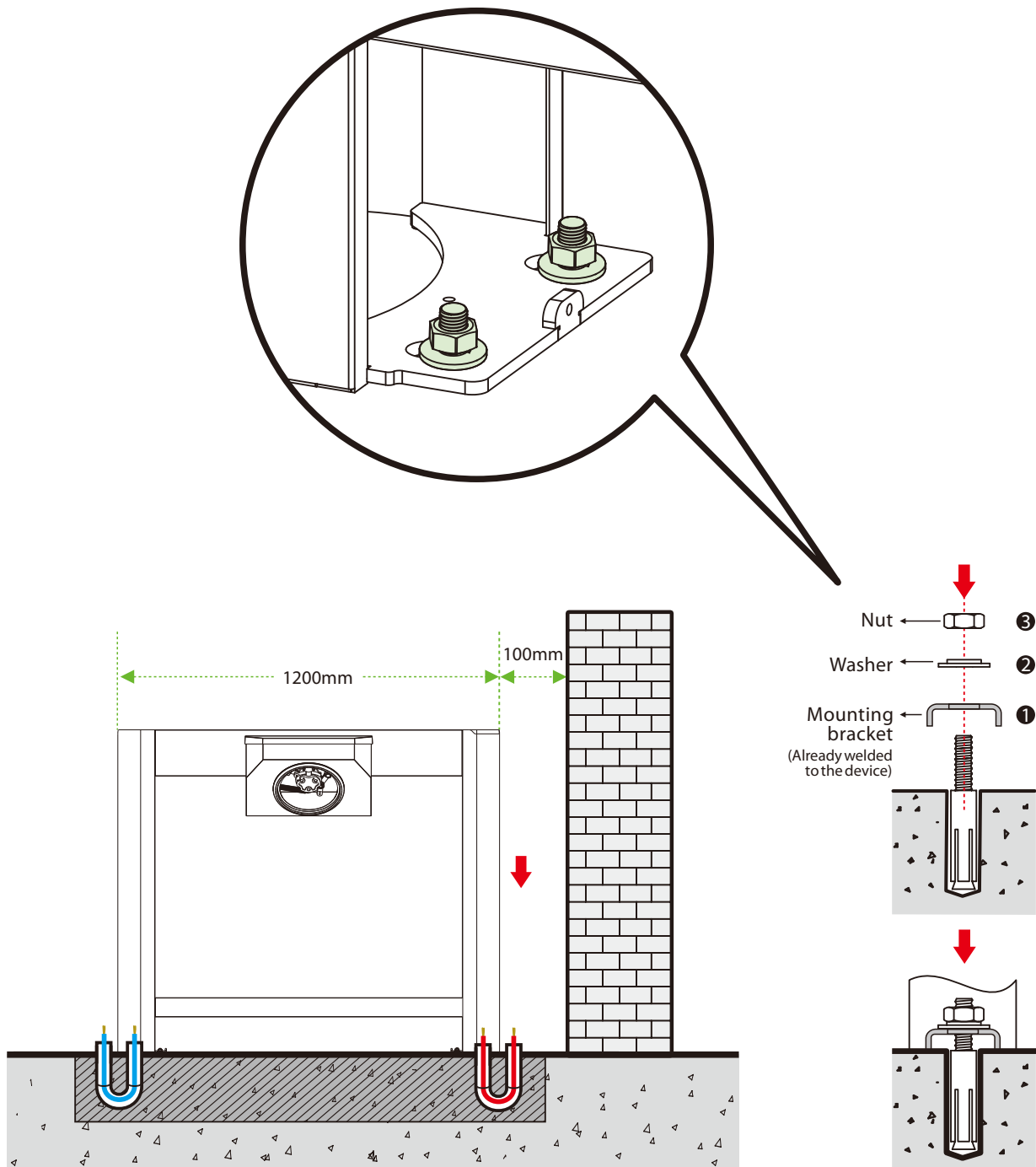

Step 6 Align the arm assembly with the internal chassis assembly, and then secure it with the screws.

Close the top lid and expansion screw cover plate, and secure with screws.

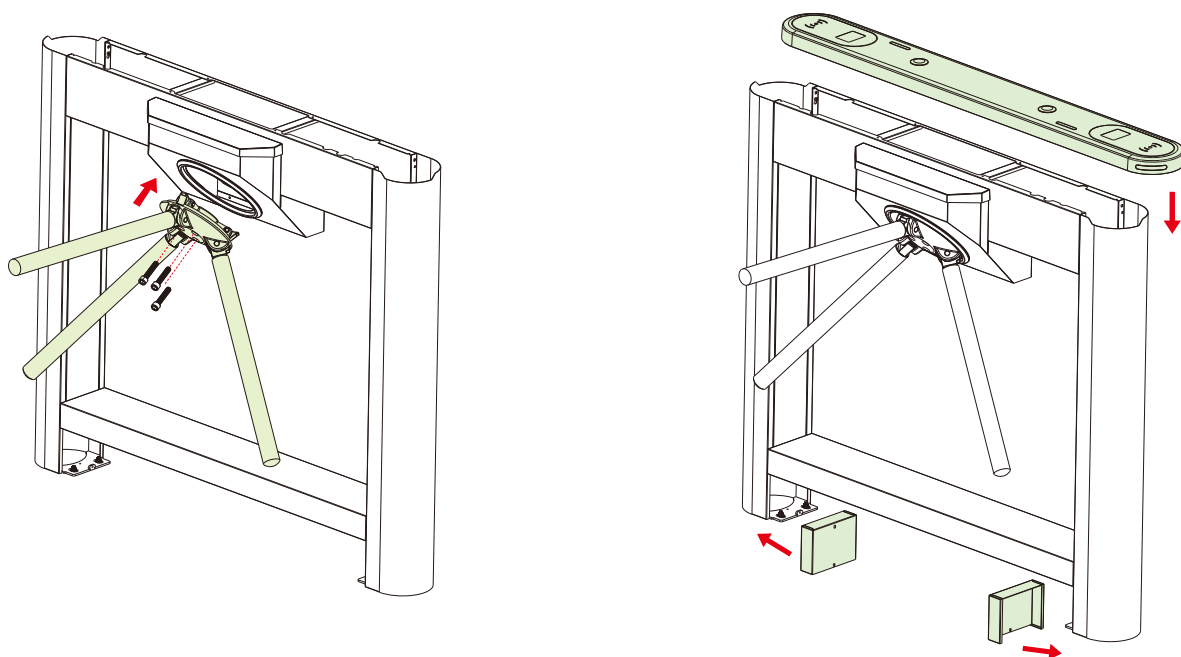

Step 7 We suggest marking a warning line on the floor after installation. This serves as a reminder for users to wait outside the marked area until the previous user completes the verification process and passes through the device.

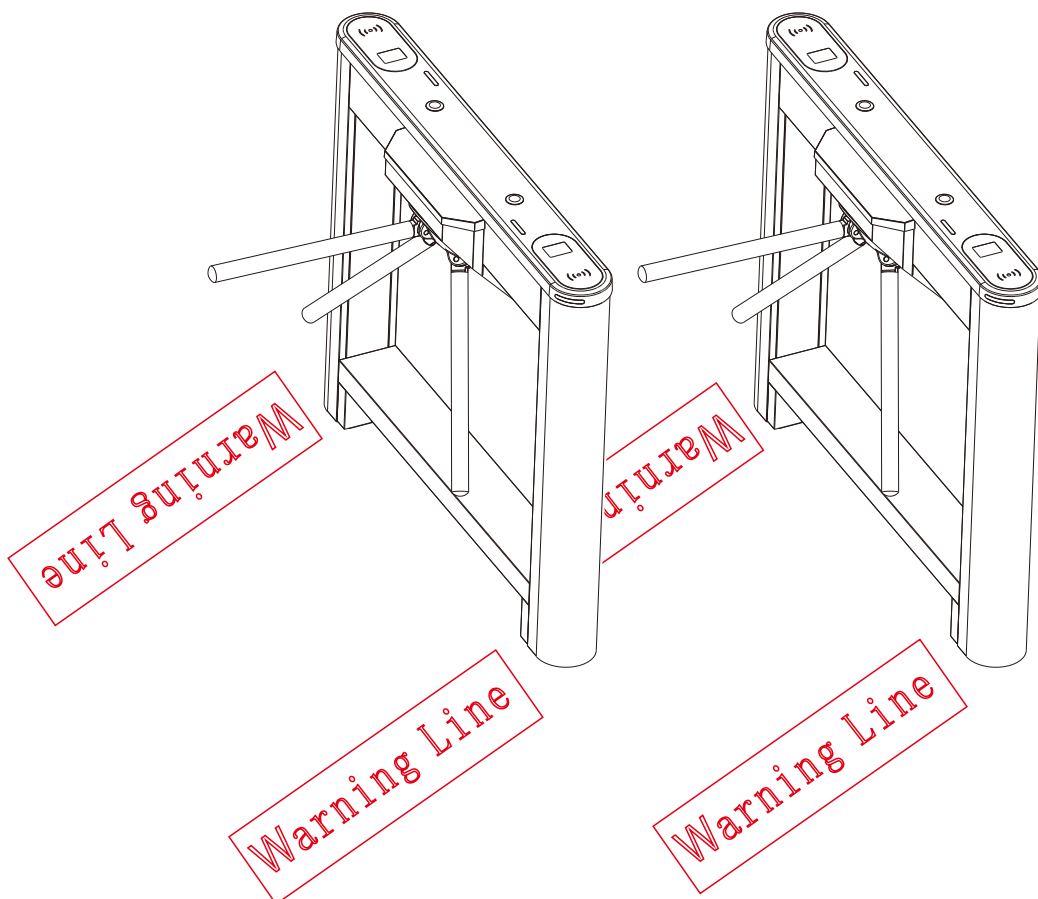

5 Wiring Diagram

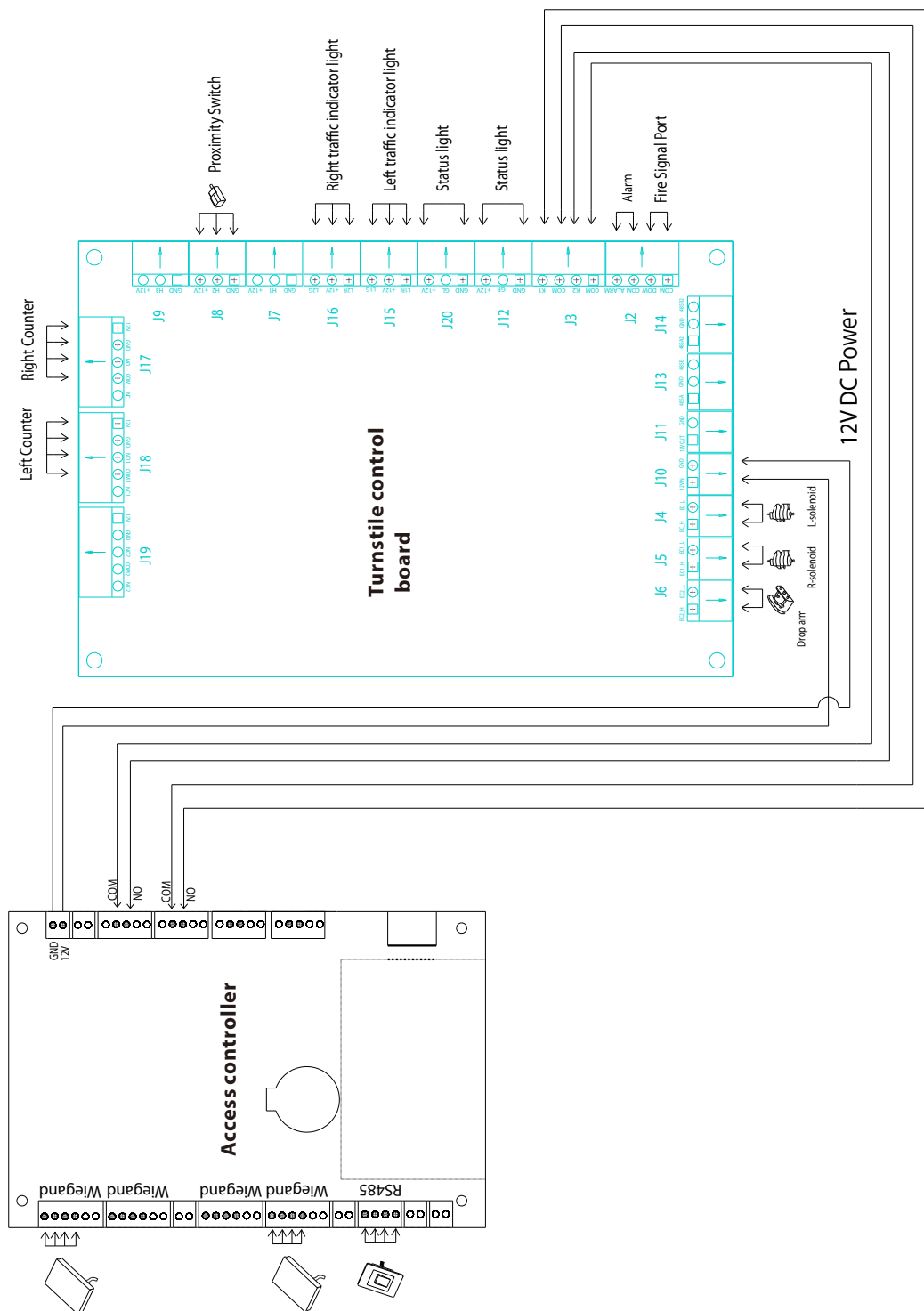

ZKTeco Industrial Park, No. 32, Industrial Road,
Tangxia Town, Dongguan, China.

Phone : +86 769 - 82109991

Fax : +86 755 - 89602394

www.zkteco.com

