

Quick Start Guide

D3 Series

Version: 1.3

Overview

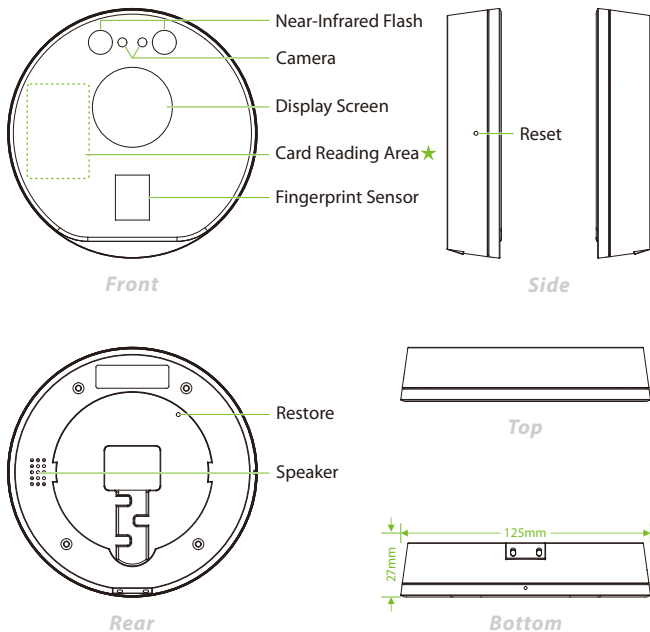

Note: Not all products have the function with★, the real product shall prevail.

Terminal Block

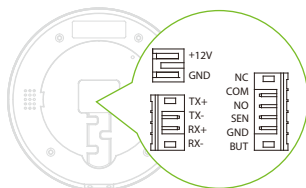

Interface	Description
	Power In
	Network Interface
	Access Control

Standalone Installation

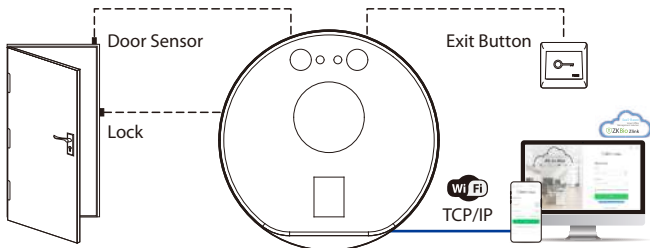

Note:

1. Make sure that the device and the PC have access to the external network before using ZKBio Zlink to bind them.
2. After successfully binding the device to ZKBio Zlink, the standby screen will display the current IP address for 30 seconds every time it is powered.

Installation Environment

Please refer to the following recommendations for installation:



KEEP DISTANCE



AVOID GLASS
REFRACTION



AVOID DIRECT
SUNLIGHT
AND EXPOSURE



KEEP EFFECTIVE
DISTANCE
0.3 to 1.6m

Power Connection

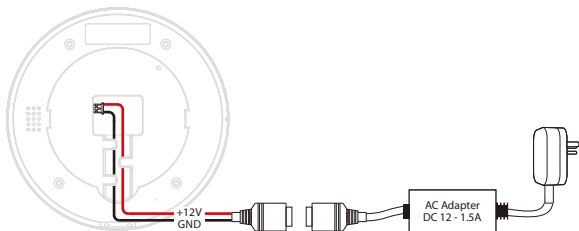

1. $12V \pm 10\%$, at least 1500mA.
2. To share the power with other devices, use an AC Adapter with higher current ratings.

Door Sensor and Exit Button Connection

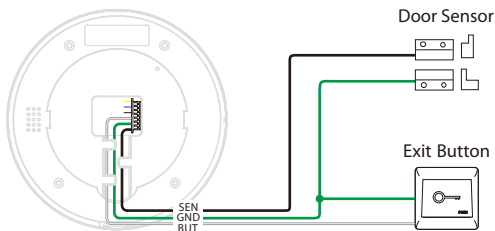

Lock Relay Connection

The system supports **Normally Opened Lock** and **Normally Closed Lock**. The **NO LOCK** (normally unlocked when power-on) is connected with 'NO' and 'COM' terminals whereas the **NC LOCK** (normally locked when power-on) is connected with 'NC' and 'COM' terminals.

Take NC Lock as an example below:

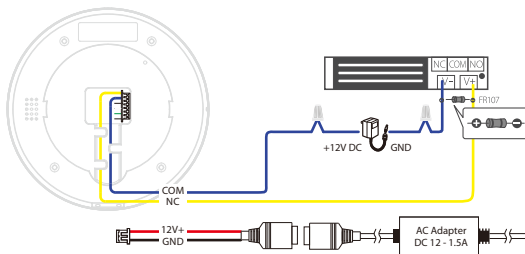

Connecting to ZKBio Zlink App

Step 1: Download the App:

Search for the **ZKBio Zlink** App in Apple App Store or Google Play Store and download the App to your smartphone.



Step 2: Create Your Account:

Open the **ZKBio Zlink** App and create an account with your phone number or Email ID.

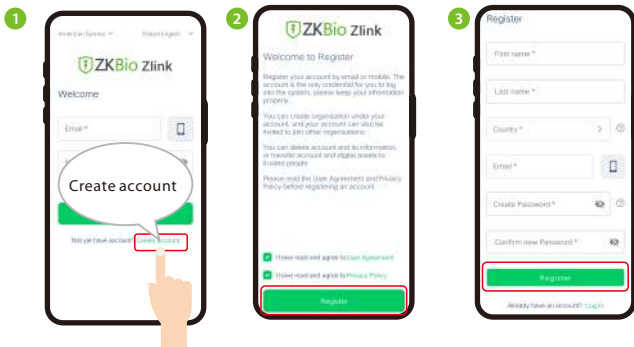

Step 3: Create the Organization:

Login with your successfully registered account and follow the page prompts to create an organization.

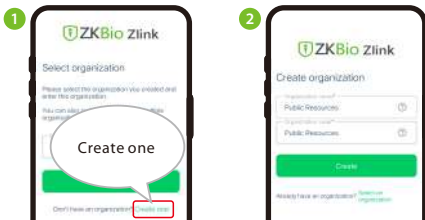

Step 4: Add the Site and Zone:

Login with the account and organization you created. After successful login, add **Site** and **Zone** in the **[Me]** module.

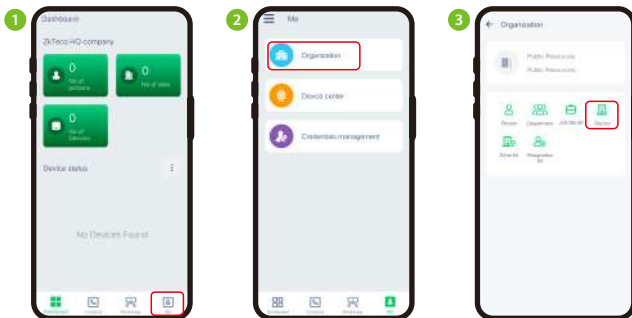

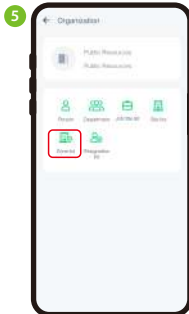

Step 5: Binding the Device:

In **[Workshop]** module, click **[CloudATT]** > **[Me]** > **[Device List]** to add devices.

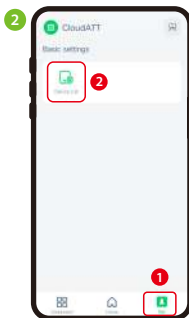
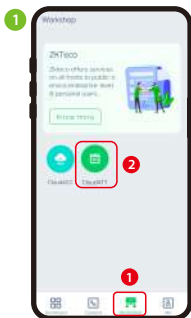

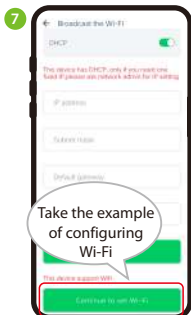

10



Note:

1. Turn on the Bluetooth function and location service on your mobile phone.
2. The device must be near the phone to avoid search failures.
3. The device can only connect to 2.4GHz Wi-Fi networks. Make sure that your phone is connected to the 2.4GHz network if you have a dual-band router with separate 2.4GHz and 5GHz networks.
4. ZKBio Zlink App currently supports Bluetooth device addition, organisation creation, and attendance report viewing, etc. More features will be added soon.

Connecting to ZKBio Zlink Web

After successfully adding devices using the ZKBio Zlink App, you can use the created account to access ZKBio Zlink Web to find devices, add new personnel, register the verification method of registered personnel, synchronize personnel to devices and query records. Access the ZKBio Zlink Web <https://zlink-web.minervaiotdev.com/>.

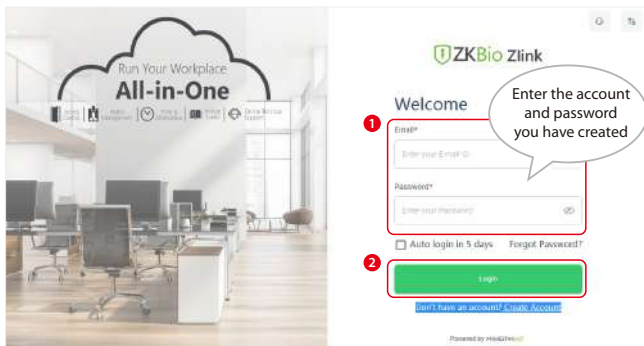

Add Person:

1. Click **[Me]** > **[Organization]** on the ZKBio Zlink Web main menu to add person.

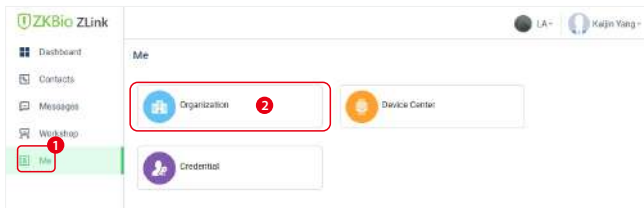

2. Click add icon **+** to add a new person. Enter the person's information, and click **[Save]**.

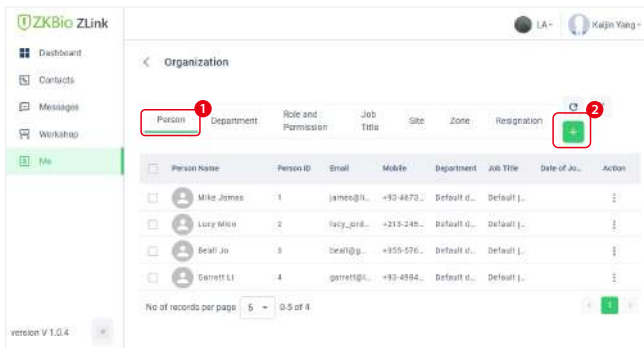

Synchronize Persons to Device:

1. Click **[Workshop]** > **[CloudATT]** on the ZKBio Zlink Web main menu.

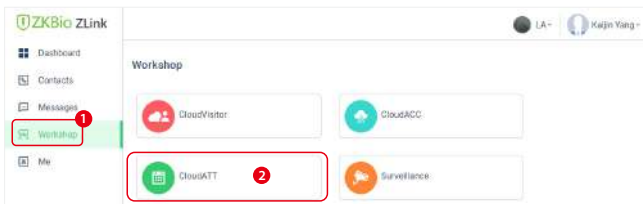

2. Click **[Attendance Rule Setting]** > **[Clocking In Device]** > **[VIEW PERSON IN THIS DEVICE]**, and click add icon **+** to choose persons to synchronize to this device.

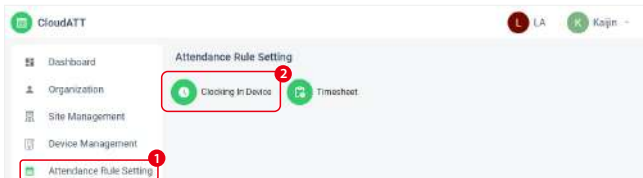

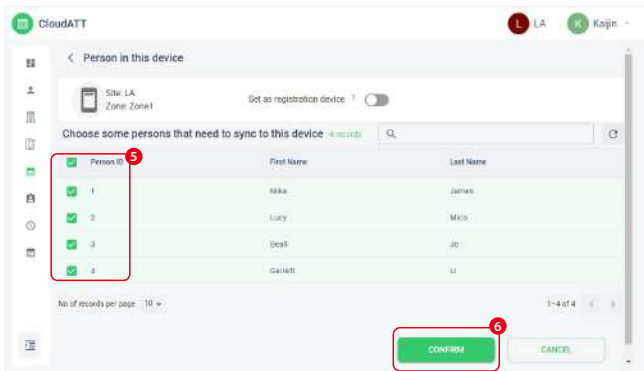
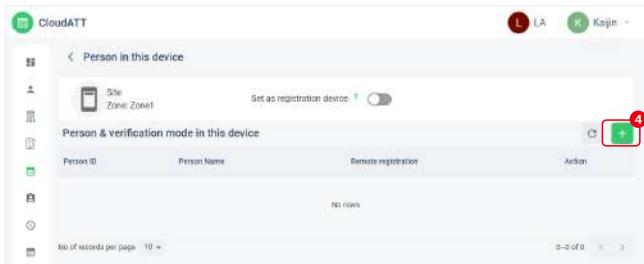

Register Verification Mode:

After the successfully synchronizing persons to device, you can view the basic information in the **[Person in this device]** interface. Click **[Workshop] > [CloudATT] > [Attendance Rule Setting] > [Clocking In Device] > [VIEW PERSON IN THIS DEVICE]**, turn on the **[Set as registration device]** and click the relevant biometric function icon (fingerprint/face/password) to remotely register the personnel biometric identification method.

Note: D3 series does not support the password method.

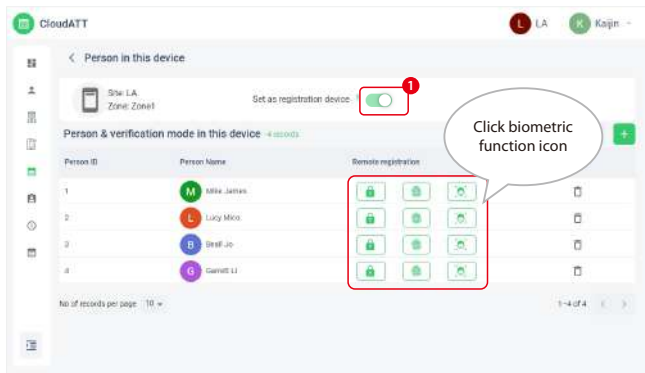

Records Query:

After the person has checked in/out on the device, you can click **[Timecard Management] > [Clocking Records]** in the **[CloudATT]** interface to view the attendance records.

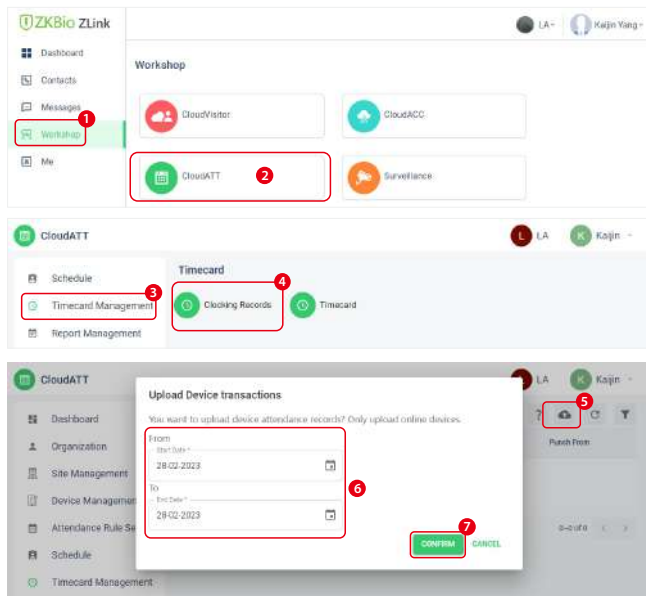

For more information on ZKBio Zlink Web functional modules, such as TimeSheet, Schedule and Report, etc, please refer the *ZKBio Zlink User Manual*.

ZKTeco Industrial Park, No. 32, Industrial Road,
Tangxia Town, Dongguan, China.

Phone : +86 769 - 82109991

Fax : +86 755 - 89602394

www.zkteco.com

