

OmniAC20

Quick Start Guide

Version: 2.3

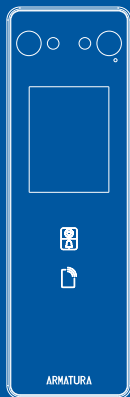

Overview

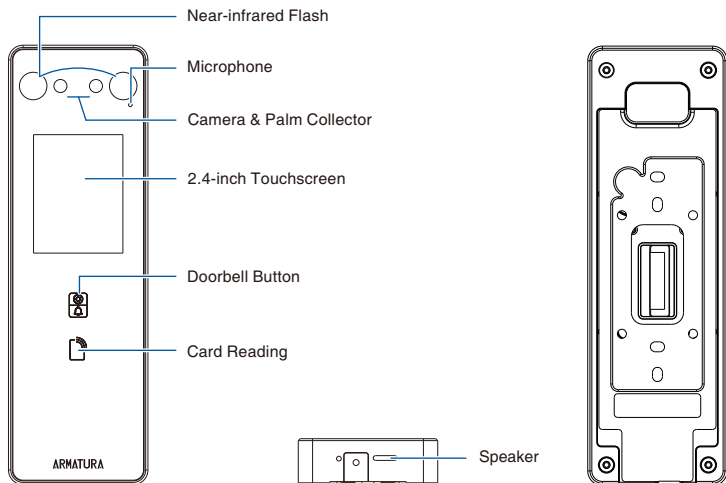

Terminal Block

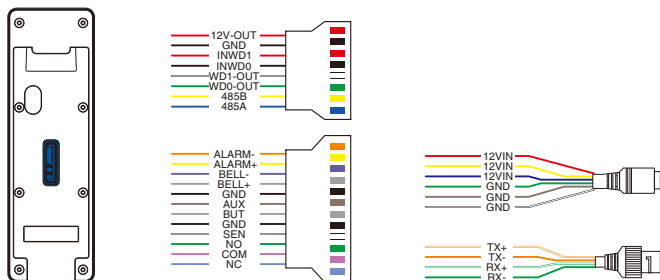

Recommended Method for Swiping Card

● The Specific Range of Card Reading Area:

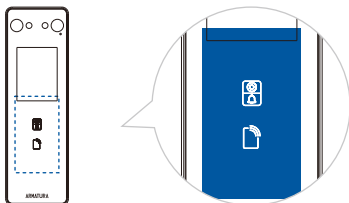

● Notes for Swiping Card:

1. Supports card orientation in horizontal, vertical, and oblique directions.
2. The card should be placed parallel to the device.
3. Ensure that the card is at the center of the card reading area.

Frequency	Protocols	Card Types	Max Range
125KHz		EM4100	0.98inch/2.5cm
		HID Prox	1.18inch/3cm
13.56MHz	ISO14443A	MIFARE	0.79inch/2cm
		DESFire	0.59inch/1.5cm
		HID iCLASS SEOS	0.39inch/1cm
		HID iCLASS/SE/SR/Elite	1.97inch/5cm
	ISO15693		
	ISO18092	FeliCa	0.79inch/2cm



AT THE CENTER
OF THE AREA



TOO CLOSE TO
THE EDGE



OUT OF THE AREA



CARD WITH
LEATHER PROTECTIVE
COVER, ETC



NOT PARALLEL
TO THE DEVICE

Installation Environment

Please refer to the following recommendations for installation.



KEEP DISTANCE



AVOID GLASS
REFRACTION



AVOID DIRECT
SUNLIGHT
AND EXPOSURE



KEEP EFFECTIVE
DISTANCE
11.81 to 78.74inch
(30 to 200cm)

Recommended Palm Gestures

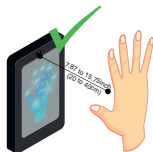

KEEP EFFECTIVE
DISTANCE OF
7.87 to 15.75 inch
(20 to 40 cm)



KEEP SPACES
BETWEEN
YOUR FINGERS



DO NOT KEEP
YOUR FINGERS
CLOSE



DO NOT KEEP
PALM OUTSIDE
COLLECTION AREA



DO NOT KEEP
YOUR FINGERS
FOLD/CURLED

Note:

1. Place your palm within 7.87 to 15.75 inch (20 to 40 cm) of the device.
2. Place your palm in the palm collection area, such that the palm is placed parallel to the device.
3. Make sure to keep space between your fingers.

Device Installation

● With Backplate:

1. Attach the mounting template sticker to the wall, and drill holes according to the mounting paper.
2. Fix the Backplate on the wall using wall mounting screws.
3. Attach the device to the Backplate.
4. Fasten the device to the Backplate with a security screw.

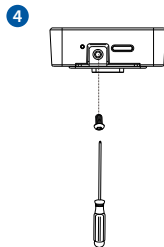
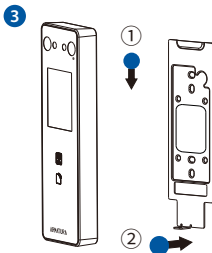
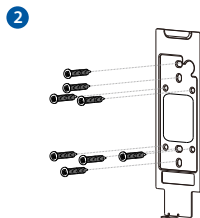
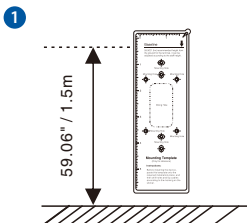

● With Back Cover ★:

1. Attach the mounting template sticker to the wall, and drill holes according to the mounting paper.
2. Fix the Back Cover on the wall using wall mounting screws.
3. Attach the device to the Back Cover.
4. Fasten the device to the Back Cover with a security screw.

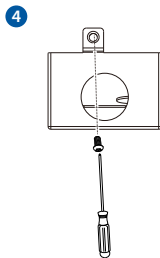
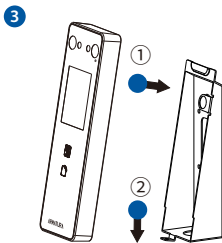
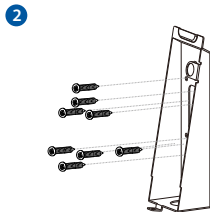
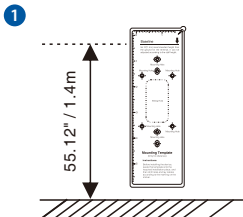

Note: Features and parameters with ★ mark are not available in all devices.

Standalone Installation

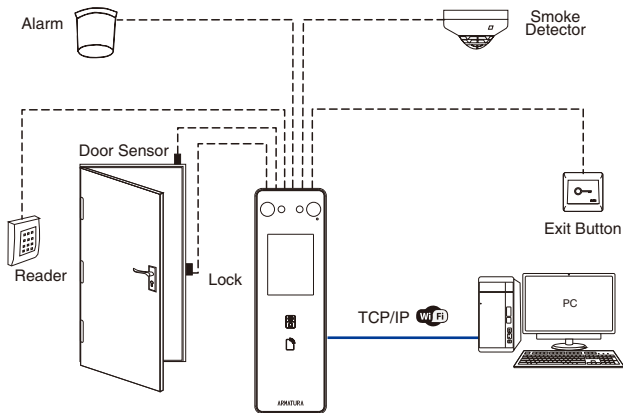

Power Connection

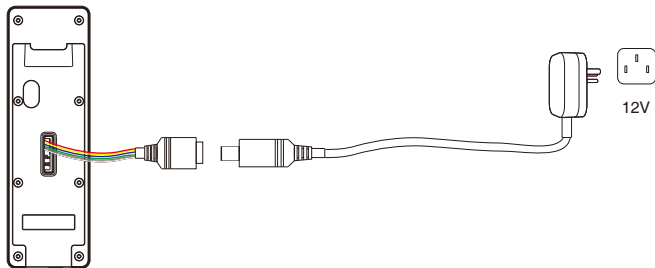

Recommended AC Adapter

1. $12V \pm 10\%$, at least 3A.
2. To share the power with other devices, use an AC Adapter with higher current ratings.

Ethernet Connection

Connect the device and computer software over an Ethernet cable. As shown in the example below:

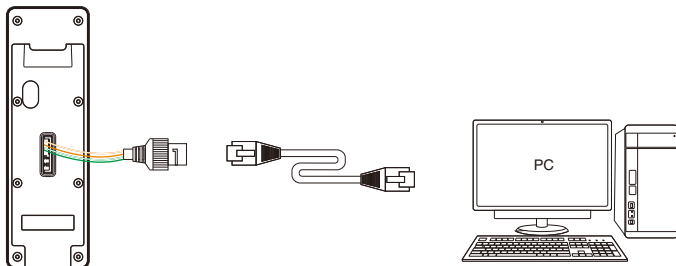

Default IP address: 192.168.1.201
Subnet mask: 255.255.255.0

IP address: 192.168.1.130
Subnet mask: 255.255.255.0

Click on [COMM.] > [Ethernet] > [IP Address] , input the IP address and click on [OK].

Note: In LAN, the IP addresses of the server (PC) and the device must be in the same network segment when connecting to the software.

Wiegand Reader Connection

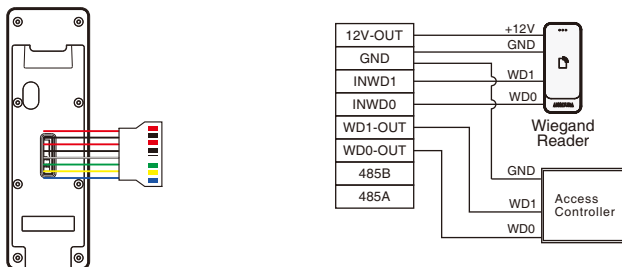

Note: 485A and 485B can be connected to the Barrier gate or the 485 Reader, separately, but cannot be connected to the gate and reader at the same time.

RS485 Connection

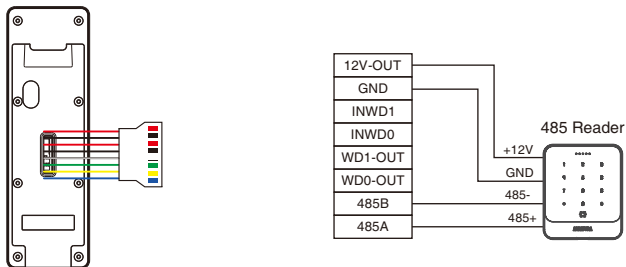

Door Sensor, Exit Button, Auxiliary Connection

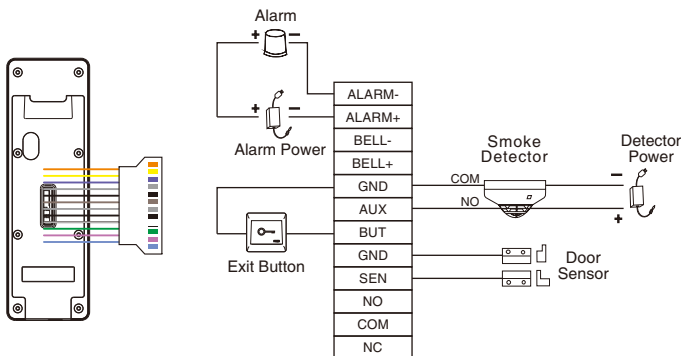

Lock Relay Connection

The system supports **Normally Opened Lock** and **Normally Closed Lock**. The **NO LOCK** (normally unlocked when power-on) is connected with 'NO' and 'COM' terminals, and the **NC LOCK** (normally locked when power-on) is connected with 'NC' and 'COM' terminals. Take NC Lock as an example below:

1) Device not sharing power with the lock

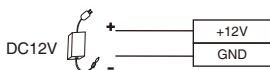

 Maximum 30V
3A input.

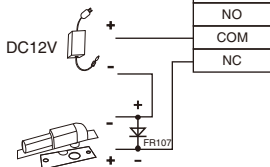

Normally Closed Lock

Do not reverse the polarity.

2) Device sharing power with the lock

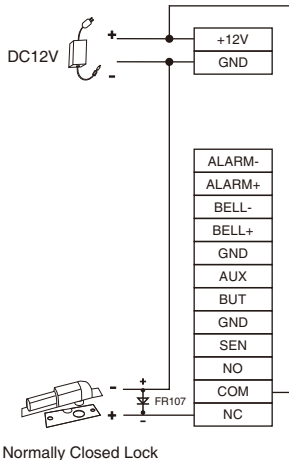

User Registration

When there is no super administrator set in the device, click on  to enter the menu. Add a new user and set User Role to Super Admin, then the system requests for the administrator's verification before entering the menu. It is recommended to register a super administrator initially for security purposes.

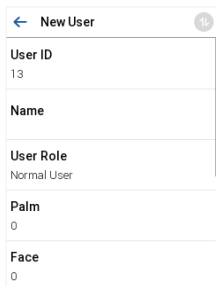
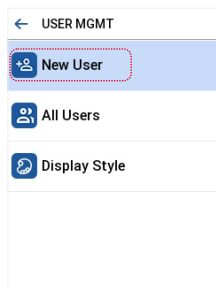
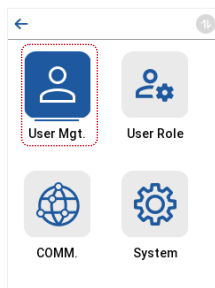
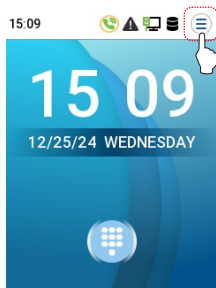

Click on  > [User Mgt.] > [New User] to register a new user. The options include entering the user ID and Name, setting User Role, registering Palm, Face, Card and Password, adding Profile Photo and Access Control Role.

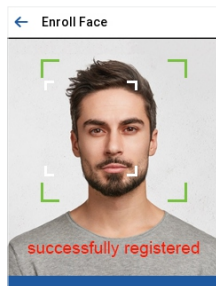
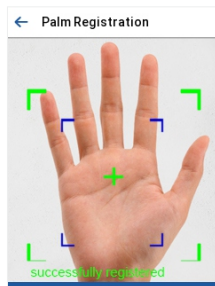

The image shows the 'New User' registration form. It has a back arrow in the top left corner and a user icon in the top right corner. The form contains the following fields:

- User ID: 13
- Name: (empty)
- User Role: Normal User
- Palm: 0
- Face: 0



Ethernet Settings

Click on  > [COMM.] > [Ethernet] to set the network parameters. If the TCP/IP communication of the device is successful, the icon  will be displayed in the upper right corner of the standby interface.

Click on  > [COMM.] > [Cloud Server Setting] to set the server address and server port, that is, the IP address and port number of the server after the software is installed. If the device communicates with the server successfully, the icon  will be displayed in the upper right corner of the standby interface.

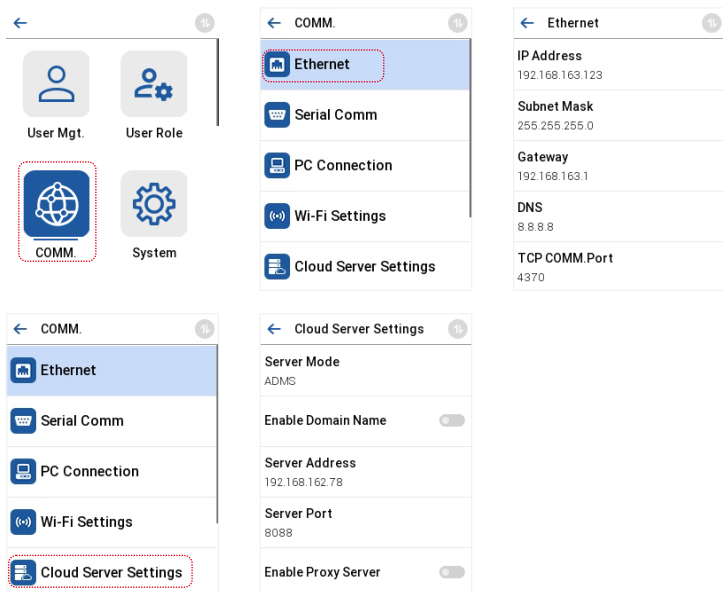

Access Control Setting

Click on  > [Access Control] to enter the access control management interface and set relevant parameters of access control.

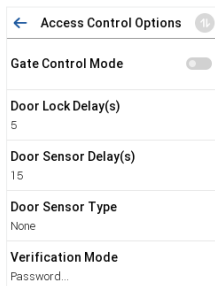
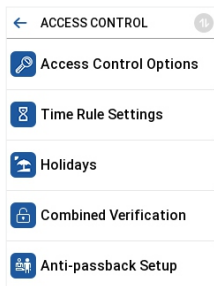
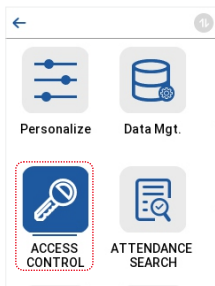

Records Query

Click on  > [Attendance Search] > [Event Logs] to enter the records query interface, input the user ID and select the time range, the corresponding event logs will be displayed.

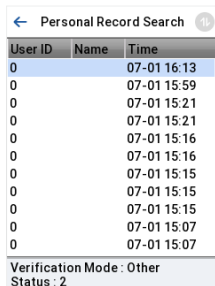
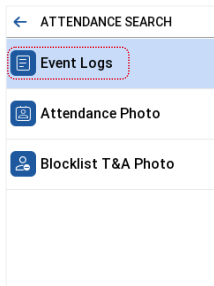
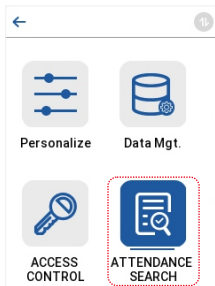

Health Protection

Click on ☰ > [System] > [Health Protection] to enable mask detection.

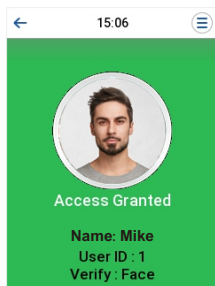
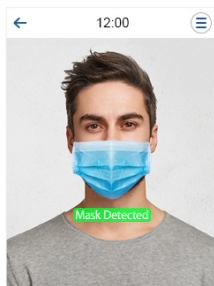
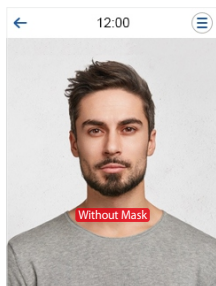
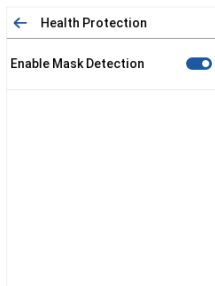
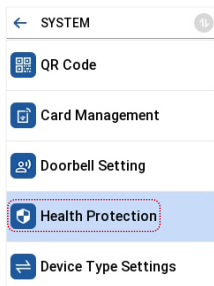
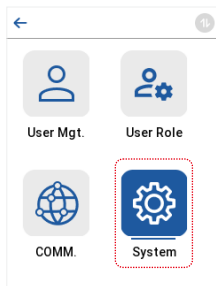

Video Intercom

1. Add the device to the Armatura One software and turn on the video intercom feature. The video intercom mode is Direct Call Mode by default. You can switch to Normal Mode in **Set up > Video Intercom Parameters**.

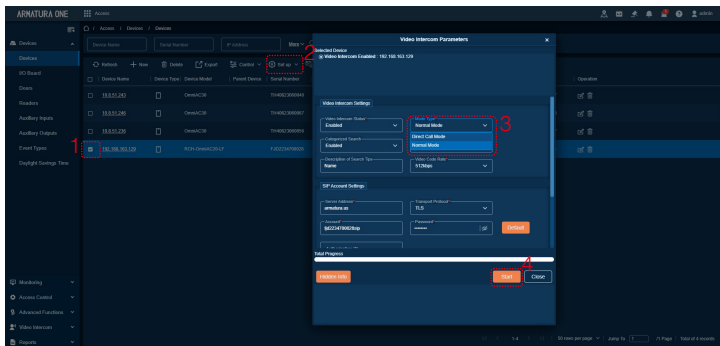
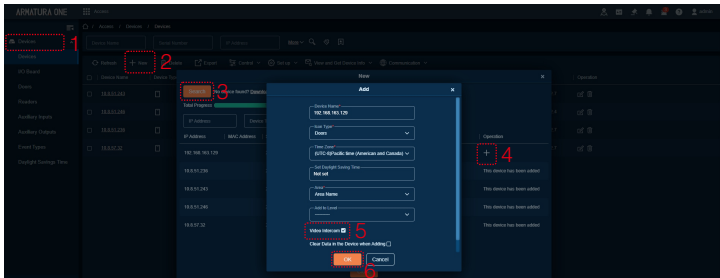

2. In the Armatura One software, click **[System] > [Integrations] > [E-mail Management] > [Email Parameter Settings]** to set up Email SMTP Service.

- Click [Access] > [Video intercom] > [Contact Book Levels] / [Contact Book] to configure contact book for the device.

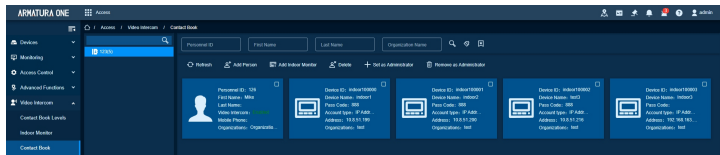

● Device Call the Phone

- Change the video intercom mode of the device to Normal Mode with Categorized Search enabled.

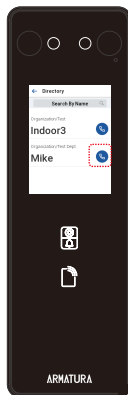
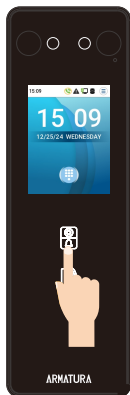

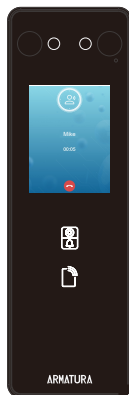

2. Change the video intercom mode of the device to Direct Call Mode.

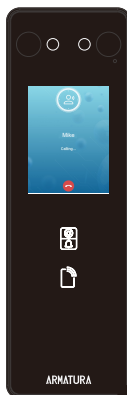
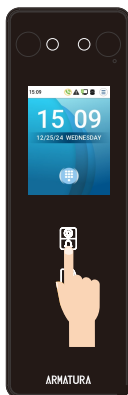

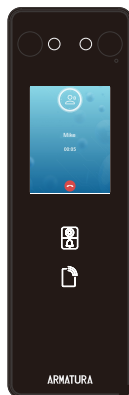

● Phone Call the Device

After the device calling the phone, the device will be automatically saved in the Armatura ICS App.

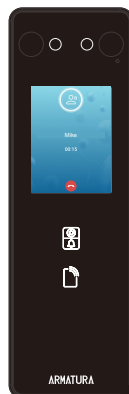
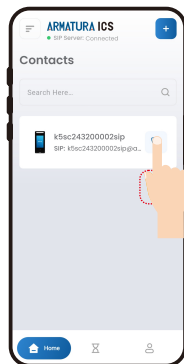

● Device Call the Indoor Monitor

When the video intercom mode of the device is Normal Mode with Categorized Search enabled, select the name of the indoor monitor to call it.

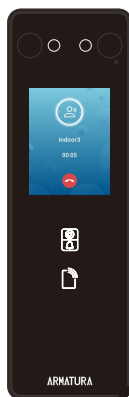
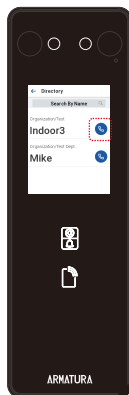
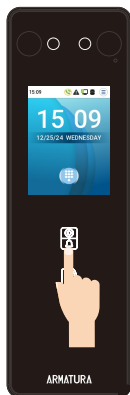

For details, please refer to OmniAC20 User Manual.

ARMATURA

ARMATURA LLC www.armatura.us E-mail: sales@armatura.us

Copyright © 2025 ARMATURA LLC. All rights reserved.