

# Quick Start Guide

---

KF1100 Pro and KF1200 Pro

Version: 1.0

# 1. Product Overview

## KF1100 Pro

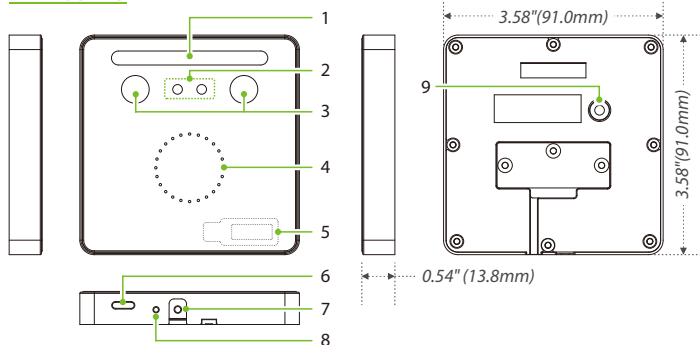

## KF1200 Pro

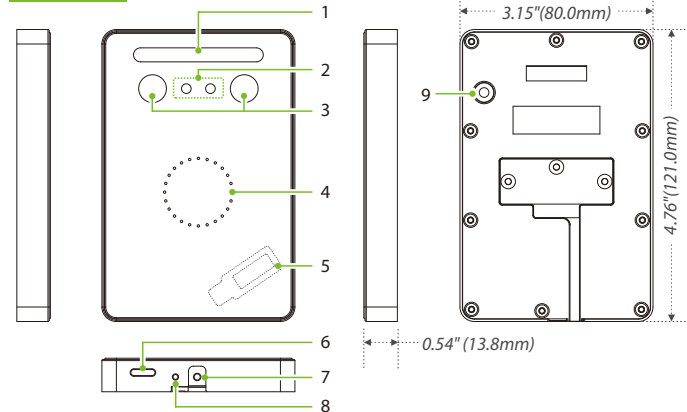

**Note:** Features and parameters with ★ mark are not available in all devices.

## Back Plate

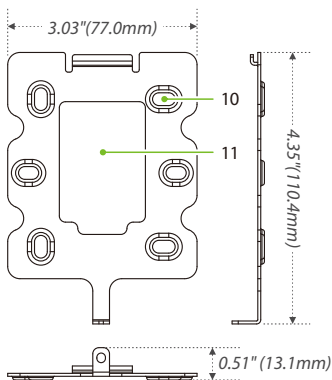
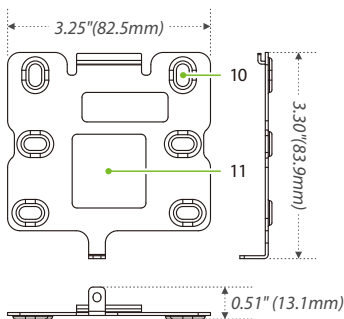

No.	Description	No.	Description
1	Flash	6	Speaker
2	Camera	7	Tamper Switch
3	Near-Infrared Flash	8	Restart Button
4	LED Indicator	9	Reset Button
5	Receive Antenna	10	Mounting Hole
	Card Reading Area	11	Wiring Hole

## 2. Installation Environment



INSTALL INDOORS  
ONLY



AVOID INSTALLATION  
NEAR  
GLASS WINDOWS



AVOID DIRECT  
SUNLIGHT  
AND EXPOSURE



AVOID USE OF ANY  
HEAT SOURCE  
NEAR THE DEVICE

### 3. Device Installation

#### Install on the wall

- ① Attach the mounting template sticker to the wall, and drill holes according to the mounting paper.
- ② Secure the back plate on the wall with the wall mounting screws.
- ③ After passing the wires through the wiring hole and connecting them to the device, and then attach the device to the back plate from top to bottom.
- ④ Fasten the device to the back plate with a security screw.

**Note:** The installation method of KF1200 Pro is the same as that of KF1100 Pro. Only KF1100 Pro is used as an example, and will not be repeated here again.

①

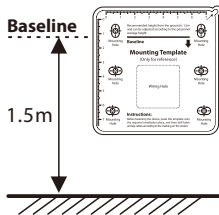

②

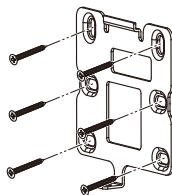

③

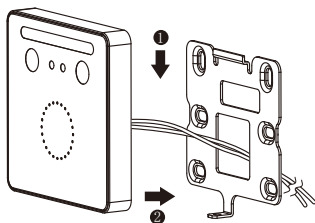

④

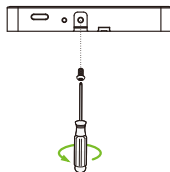



## 4. Standalone Installation

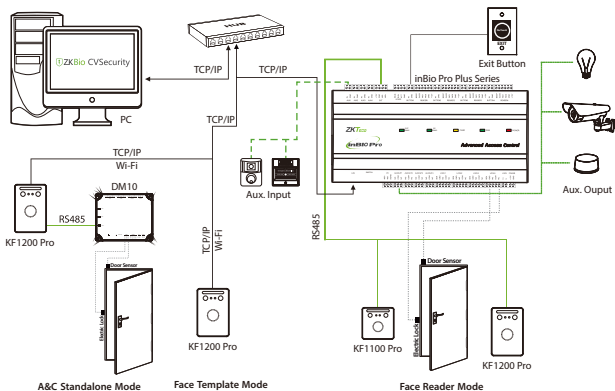

## 5. Terminal Block

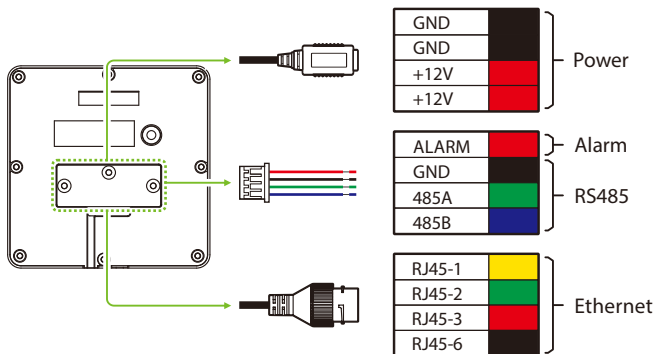

## 6. Power Connection

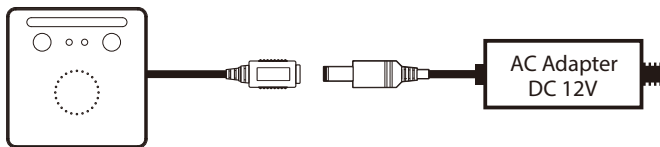

- Minimum AC adapter:**12V, 1.5A**, Recommended AC adapter:**12V, 3A**.
- Use an AC adapter with a higher current rating to share power with the other devices.

## 7. Ethernet Connection

Connect the device and the computer software over an Ethernet cable.  
As shown in the example below:

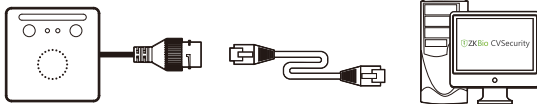

Default IP address: 192.168.1.201  
Subnet mask: 255.255.255.0

IP address: 192.168.1.130  
Subnet mask: 255.255.255.0

On the WebServer page, click **[Advanced Settings] > [COMM.] > [IP Address]** to change the IP address and then click **[Confirm]**.

**Note:** In LAN, the IP addresses of the server (PC) and the device must be in the same network segment while connecting to the ZKBio CVSecurity software.

## 8. Device Operating Mode

The KF1000 Pro series has three device operating modes: Standalone Mode, Reader Background Identifying Mode and Face Server Mode.

### 1. Standalone Mode

In the standalone mode, the KF1000 Pro series can be used as an standalone to connect with the DM10 as shown in the wiring diagram below.

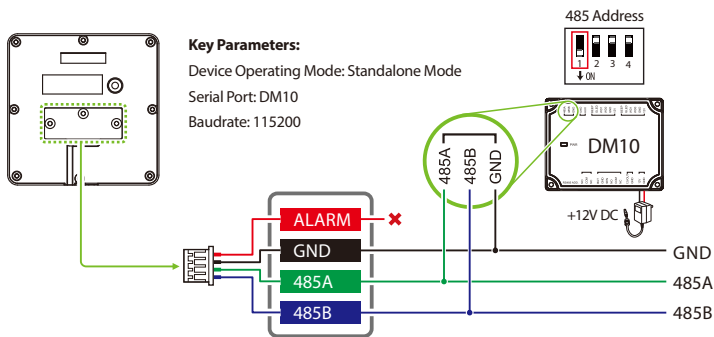

#### Note:

1. First you need to switch the operating mode to standalone mode on the WebServer, set the path to: **[Advanced Settings] > [System] > [Device Operating Mode] > [Standalone Mode]**.
2. And then you need to manually enable the DM10 function on the WebServer to access. The path: **[Advanced Settings] > [Serial Comm] > [Serial Port] > [DM10]**.
3. A KF1000 Pro series only supports connecting one DM10.
4. Set the 485 address of DM10 to 1.
5. Each device requires a separate power supply.
6. For more details, please refer to the User Manual.

## 2. Reader Background Identifying Mode

In reader mode, the KF1000 Pro Series can communicate with the inBio Pro Plus controller via RS485. The wiring diagram is shown below.

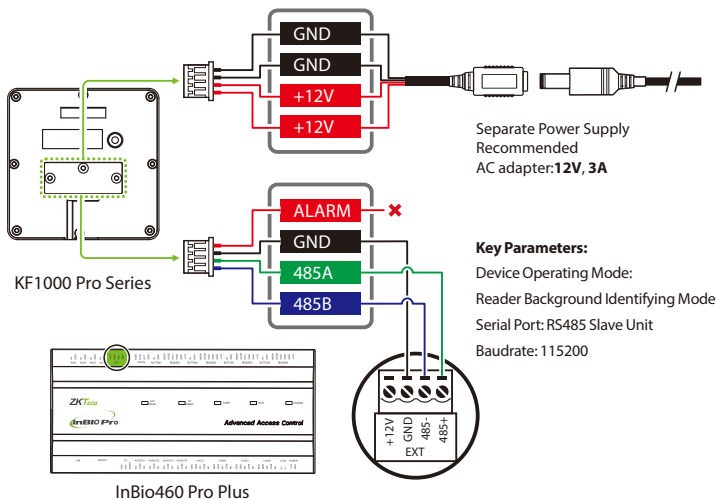

### Note:

1. First you need to switch the operating mode to Reader Background Identifying Mode on the WebServer. The setting path is: **[Advanced Settings] > [System] > [Device Operating Mode] > [Reader Background Identifying Mode]**.
2. And then you need to set the serial port as RS485 Slave Unit on the WebServer. The path: **[Advanced Settings] > [Serial Comm] > [Serial Port] > [RS485 Slave Unit]**.
3. Each KF1000 Pro series requires a separate power supply.
4. Set the relevant parameters for the controller in the software, see the User Manual for details.
5. Once completed, the registered user information can be verified on the reader.

### 3. Face Server Mode

In Face Server mode, the KF1000 Pro Series can be used as a converter to capture face templates from photos sent by the software, store them in the software, and then send the face templates to the controller through the software for verification and comparison. Refer to the following procedure to set up.

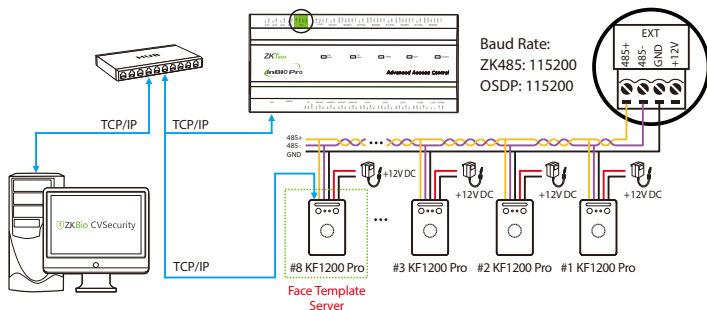

#### Note:

1. Plug in the network cable to the KF1000 Pro Series reader. When more than one reader is connected to the line, you can select any one of them as a converter and plug in the network cable for it.
2. Click **Personnel** > **Personnel** > **Parameters** to enable facial template extraction on the software side.
3. The facial template extraction function can be enabled in either Standalone Mode or Reader Background Identifying Mode.
4. Refer to the User Manual for more parameter settings.

## 10. Login to the WebServer

After the device is powered on, connect the device using a cable network to access the WebServer by entering the IP address and the server port in the address bar of your browser.

The IP address is set as: <https://device IP address: port>. By default, the port is **1443**.

For example: **https://192.168.1.201:1443**

User name: **admin**

Password: **admin@123**

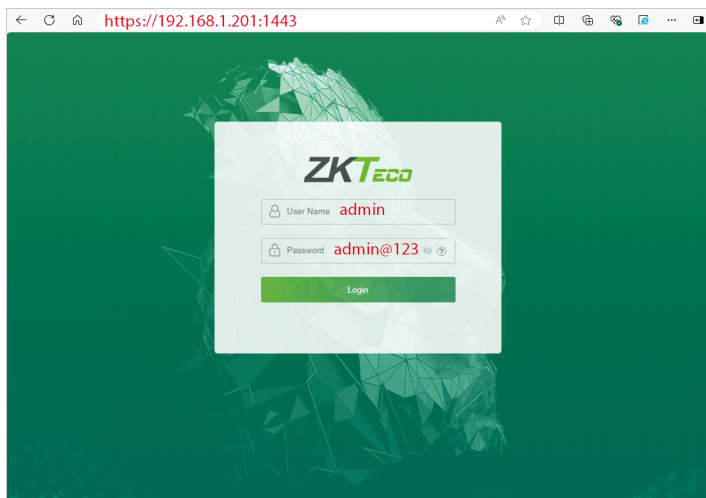

**Note:** After logging in for the first time, the user needs to change the original password and then log in again before it can be used.

## 11. Quick Start

User Registration → User Authentication → Verified → View Records

### 1. User registration

#### Method 1: Registering on the WebServer

Click **[User Mgt.]** > **[All Users]** > **[New User]** to register a new user on the WebServer. Enter the User ID, Name, Password, Card, setting user role and access control role.

The screenshot displays the ZKTeco WebServer interface. On the left is a dark sidebar menu with the following items: System Info, Device Info, Device Capacity, Firmware Info, User Mgt., All Users (highlighted with a red box and a red circle with the number 1), Advanced Settings, COMM., Connection Settings, Cloud Service Setup, Wi-Fi Settings, Date Setup, and System. The main content area is titled 'Basic Info' and contains a registration form. The form fields are: User ID (value: 2), Name (value: Mick), Rights (value: Normal User), Password (value: \*\*\*\*\*), Card Number (value: 7234891), and Access Control Role (value: 1). A red box encloses the User ID, Name, Rights, Password, Card Number, and Access Control Role fields. A green callout bubble with a red circle containing the number 2 points to this red box and contains the text 'Enter the User Info.'. Below the form are two buttons: 'Confirm' (highlighted with a red box and a red circle with the number 3) and 'Back'. Below the 'Basic Info' section is the 'Online Registration' section, which contains a 'Face' field and a 'Register' button (highlighted with a red box and a red circle with the number 4). A green callout bubble with a red circle containing the number 4 points to the 'Register' button and contains the text 'Enroll Face on the device.'. A 'Register' button is also located to the right of the form fields.

After entering the basic information of the user, click **[Confirm]**, and then select the face and click **[Register]**. Follow the device prompts to face the camera and record the face until the LED indicator turns green.

## Method 2: Registering on the software (ZKBio CVSecurity)

1. Click [**Advanced Settings**] > [**COMM.**] > [**IP Address**] to set the IP address and then click [**Cloud Service Setup**] to set cloud service address on the WebServer. As shown in the figure below.

**ZKTECO**

**System Info**

- Device Info
- Device Capacity
- Firmware Info
- User Mgt.
- All Users
- Advanced Settings**
- COMM.** 1
- Connection Settings
- Cloud Service Setup
- Wi-Fi Settings

**IP Setup**

IP Address: 192.168.163.58

Subnet Mask: 255.255.255.0

Gateway: 192.168.163.1

DNS: 114.114.114.114

2 Enter the IP Info.

3 Confirm

**ZKTECO**

**System Info**

- Device Info
- Device Capacity
- Firmware Info
- User Mgt.
- All Users
- Advanced Settings**
- COMM.
- Connection Settings
- Cloud Service Setup** 1
- Wi-Fi Settings

**Cloud Server Settings**

Enable Domain Name: ☐ 2

Cloud Server Address: 192.168.163.61

Cloud Service Port: 8088

HTTPS: ☒

Proxy Server Setup: ☐

2 Enter the Sever Info.

3 Confirm

**Cloud Server Address:** This is the IP address after the software installation.

**Cloud Service Port:** Default is 8088.



2. Click **[Access]** > **[Access Device]** > **[Device]** > **[Search]** to search the device on the software. When an appropriate server address and port is set on the device, the searched devices are then displayed automatically.

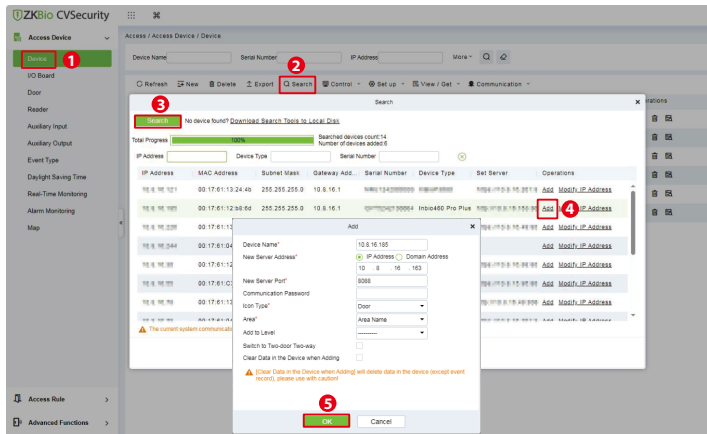

3. Click **[Add]** in an operation column, a new window will pop-up. Select Icon Type and Area from each dropdowns and click **[OK]** to add the device.

4. Click **[Personnel]** > **[Person]** > **[New]** and fill in all the required fields to register new users in the software. **Note:** The card number must be entered for use with the inBio Pro Plus series controllers.

5. Click **[Access]** > **[Access Device]** > **[Device]** > **[Control]** > **[Synchronize All Data to Devices]** to synchronize all the data to the device including the new users.

For more details, please refer to the ZKBio CVSecurity User Manual.

## 2. User Authentication

The terminal can detect the face within a range of **0.3 to 1.5 metres**. When the device senses a change in external brightness, it changes to the face verification interface automatically and when the device indicator turns green, the verification method is successful.

### 3. View records

Click **[Access]** > **[Access Control Reports]** > **[All Transactions]** on the software to view the records.

## 12. Wi-Fi Settings★

Click **[Advanced Settings]** > **[Wi-Fi Settings]** to enable the Wi-Fi function, select a Wi-Fi and enter the password. Until the connection status shows “Connected” which indicates that the Wi-Fi connection is successful.

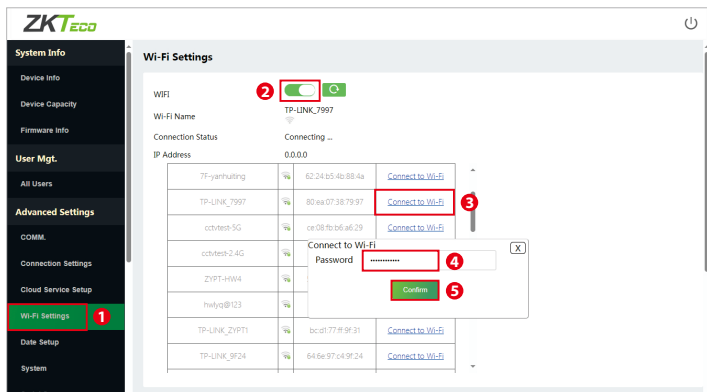

## 13. Factory Reset

If you forget the WebServer password, you can restore the factory settings by pressing and holding the reset button for **5** seconds, and then logging in again with the initial password.

**Note:** This function does not have any clear registered user data.

ZKTeco Industrial Park, No. 32, Industrial Road,  
Tangxia Town, Dongguan, China.

Phone : +86 769 - 82109991

Fax : +86 755 - 89602394

[www.zkteco.com](http://www.zkteco.com)

