

# EL-52T28I

## 2MP H.265 IP Camera



True WDR



H.265



6KV  
Protection



3D DNR



IP67



Starlight

### Features

- 2.0MP H.265 real-time coding
- 3D DNR, True WDR
- IR-Cut filter, Day&Night
- PoE power supply
- Lightning Protection up to 6KV
- IP67 ingress protection
- Support iOS/Android Phone/Pad, remote monitoring
- Video Linkage with Access Control System(BioSecurity 3.0)

### Dimensions

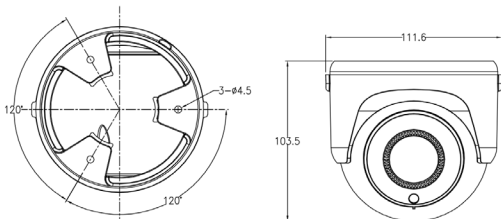

### Specifications

|                      |  |
|----------------------|--|
| Model                | EL-52T28I  |
| <b>Camera</b>        |  |
| Image Size           | 1920*1080  |
| Image Sensor         | 2.0MP 1/2.8" Progressive Scan CMOS   |
| Min. illumination    | Color: 0.01Lux @(F1.2,AGC ON); 0 Lux with IR<br>B/W: 0.001 Lux @ (F1.2,AGC ON); 0 Lux with IR  |
| Shutter Time         | 1/25s to 1/10,000s   |
| Lens                 | 2.8-12mm Motorized   |
| Lens Mount           | Φ14  |
| Horizontal FOV       | 30°-105°   |
| Day & Night          | IR-Cut filter with auto switch   |
| Digital NR           | 3D DNR   |
| IR Range             | 20-30m   |
| <b>Image</b>         |  |
| Resolution           | 1080P(1920*1080), 1.3MP(1280*960),<br>720P (1280 * 720P), D1, CIF                              |
| Main Stream          | 1080P@25fps  |
| Sub Stream           | 704*576@25fps  |
| Third Stream         | 1280*720@25fps   |
| Image Settings       | Saturation, Brightness and Contrast are adjustable<br>through Web browser or Client software.  |
| <b>Compression</b>   |  |
| Video Compression    | H.265/H.264  |
| Bite Rate            | 32Kbps~8Mbps   |
| Encode Mode          | VBR/CBR  |
| Audio                | G.711A/G.711Mu/G.726/G.726ASF  |
| <b>Interface</b>     |  |
| Ethernet             | 1*10/100Mbps RJ45 Ethernet port  |
| Audio I/O            | N/A  |
| <b>Network</b>       |  |
| Network Storage      | Support 802.1X   |
| Alarm Trigger        | Motion Detection, Private Mask, Local Alarm, etc.  |
| Network Protocols    | TCP/IP, UDP, HTTP, IGMP, ICMP, DHCP, RTP/RTSP,<br>DNS, DDNS, FTP, NTP, PPPOE, UPNP, SMTP, SNMP |
| Interface Protocol   | ONVIF Profile S/API  |
| ROI                  | Support 4 fixed region for mainstream<br>and sub stream separately                             |
| Line Cross Detection | Cross a pre-defined virtual line, up to<br>1 pre-defined virtual lines supported               |
| General Function     | Anti-flicker, Dual-stream, Image Capture,<br>Password Protection                               |
| <b>General</b>       |  |
| Temperature          | -30 C ~ 60 C   |
| Humidity             | 10%-90% RH   |
| Power Supply         | DC12V±10% 2A, PoE; Max. 3W   |
| Protection Level     | IP67   |
| Weight               | 400g   |
| Dimensions           | Φ111.6*105mm   |

